

Data

Thickness of brake disc	10
Perm. refinishing on each brake surface	0.3
Wear limit	9.02
Brake disc dia.	279 ± 0.2
Fitted bore dia.	67.00 67.05
ID for parking brake	160 ± 0.2
Lateral runout	max. 0.12

Special Tool

Measuring device	001 589 28 21 00
------------------	------------------

Lubricant

Molykote paste U	Molykote paste G Rapid	Liqui-Moly paste 36
------------------	------------------------	---------------------

Removal

1 Unbend lock plate (3) and unscrew hex. screws (2). Remove caliper and on vehicles with diagonal

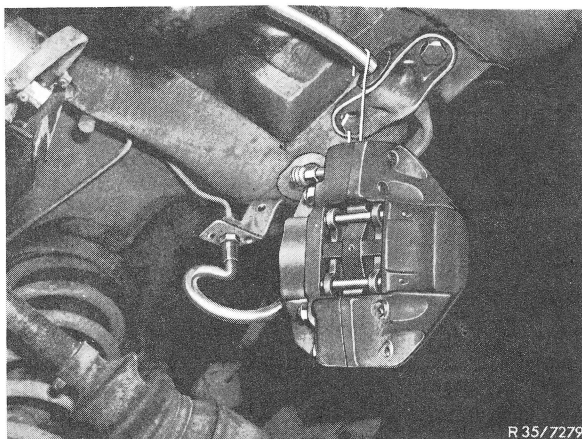

Fig. 1

swing axle attach together with brake hose and by means of a suitable hook to torsion bar (Fig. 1, 4, 5 and 6).

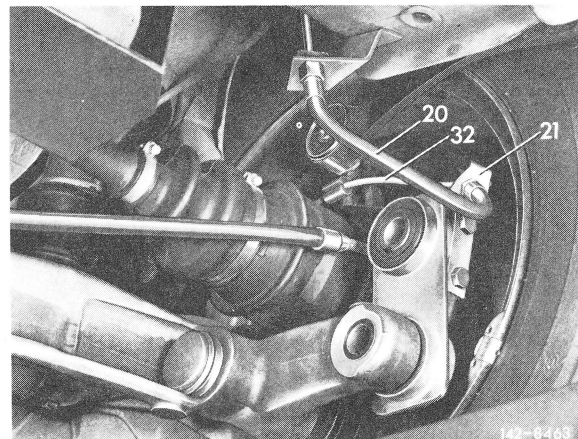

Fig. 2

20 Brake hose
21 Brake hose holder

32 Brake line

42.1 Removal and Installation of Brake Disc on Rear Axle

2 On vehicles with diagonal swing axle with starting torque compensation, unscrew hex. screws for attaching brake hose holder (21) from brake caliper bracket (Fig. 2). Then also attach caliper to torsion bar by means of a hook.

Note: The hook is self-made. **Brake hose should not be subject to tensile stress.**

3 Remove brake disc (12) from rear axle shaft flange (15).

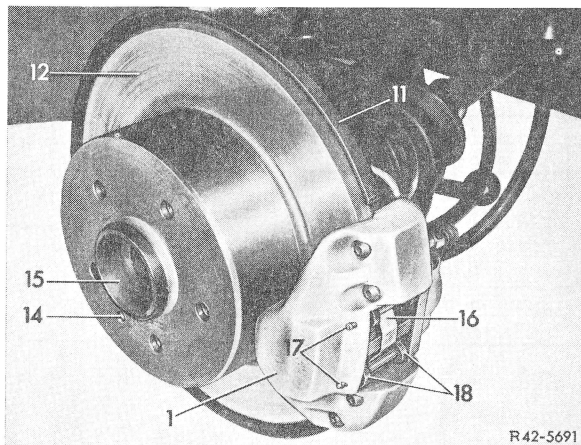

Fig. 3

- | | |
|----------------|---------------------------|
| 1 Caliper | 15 Rear axle shaft flange |
| 11 Cover plate | 16 Cross spring |
| 12 Brake disc | 17 Holding pin |
| 14 Set pin | 18 Brake pad |

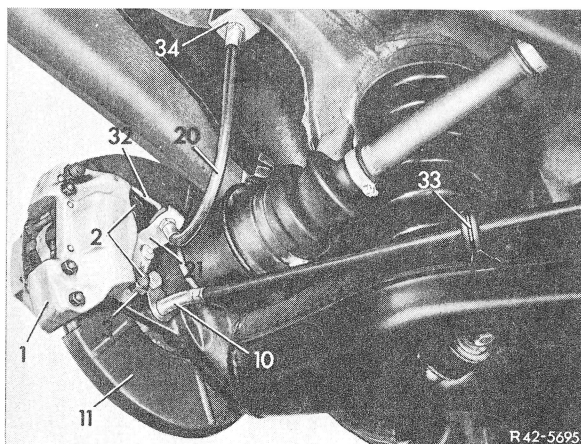

Fig. 4

Brake line layout version 1

- | | |
|------------------------|--|
| 1 Caliper | 21 Brake hose holder |
| 2 Hex. screw | 32 Brake line |
| 3 Lock plate | 33 Holder for brake cable control with rubber sleeve |
| 10 Brake cable control | 34 Holder on frame floor |
| 11 Cover plate | |
| 20 Brake hose | |

Loosen stuck brake discs from seat of rear axle shaft flange by applying light blows with a plastic hammer. Make sure that parking brake is completely released (Fig. 3).

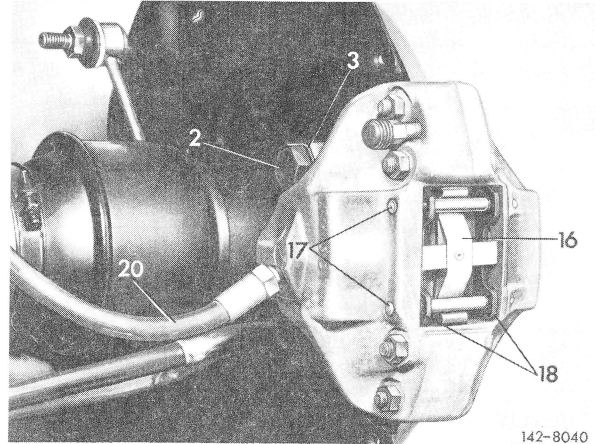

Fig. 5

Brake line layout version 2

- | | |
|-----------------|----------------|
| 2 Hex. screw | 17 Holding pin |
| 3 Lock plate | 18 Brake pad |
| 16 Cross spring | |

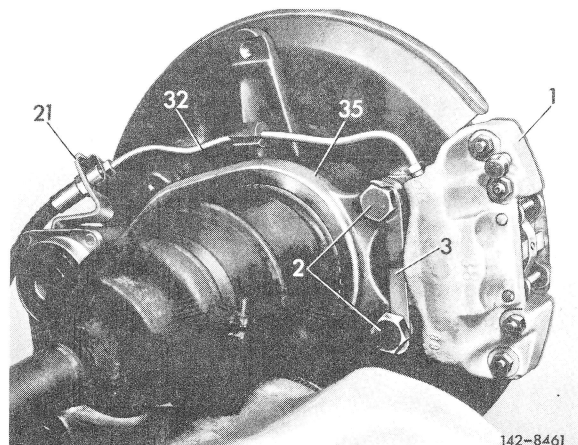

Fig. 6

Layout of diagonal swing axle with starting torque compensation

- | | |
|--------------|----------------------|
| 1 Caliper | 21 Brake hose holder |
| 2 Hex. screw | 32 Brake line |
| 3 Lock plate | 35 Caliper bracket |

Installation

4 Rub fitted seat of rear axle shaft flange with a heat-resistant permanent lubricant (Molykote paste „U“, Molykote paste G Rapid, Liqui-Moly-paste 36), so that brake disc can be easily removed from rear axle shaft flange later.

Caution! When using a new brake disc, remove anti-corrosion paint from brake disc prior to installation.

5 Position brake disc (12) on rear axle shaft flange. Make sure that set pin (14) is entering correctly into brake disc (Fig. 3, 7, 8 and 9).

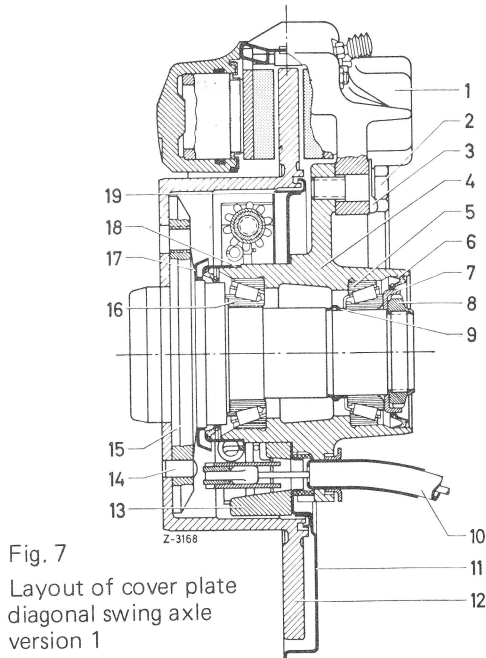

Fig. 7

Layout of cover plate diagonal swing axle version 1

- | | |
|--------------------------------|---------------------------------|
| 1 Caliper | 11 Cover plate |
| 2 Hex. screw | 12 Brake disc |
| 3 Lock plate | 13 Supporting web |
| 4 Wheel carrier | 14 Set pin |
| 5 Inner tapered roller bearing | 15 Rear axle shaft flange |
| 6 Radial sealing ring | 16 Outer tapered roller bearing |
| 7 Seal running ring | 17 Dust cap |
| 8 Slot nut | 18 Radial sealing ring |
| 9 Spacer sleeve | 19 Brake carrier |
| 10 Brake cable control | |

6 Position caliper against holder of wheel carrier (4). Then screw hex. screw (2) into holder using a new lock plate (3) (Fig. 7 to 9), tighten to 90 Nm (9 kpm) and secure.

7 On vehicles with diagonal swing axle with starting torque compensation, attach brake hose holder to caliper brakcet (Fig. 2).

8 Attach brake disc with spherical collar screws to rear axle shaft flange and measure lateral runout of brake disc at outer diameter.

9 Caution! Prior to moving off, actuate brake pedal several times energetically, so that correct clearance between brake disc and brake pad is established. Then supplement supply of brake fluid in compensating tank of tandem master dylander.

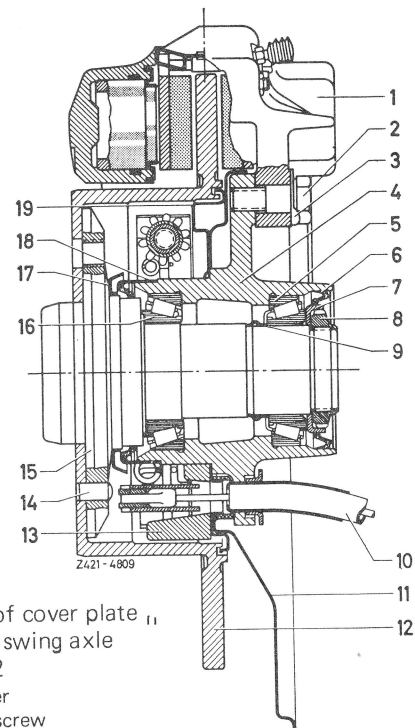

Fig. 8

Layout of cover plate diagonal swing axle version 2

- | | |
|--------------------------------|---------------------------------|
| 1 Caliper | 12 Brake disc |
| 2 Hex. screw | 13 Supporting web |
| 3 Lock plate | 14 Set pin |
| 4 Wheel carrier | 15 Rear axle shaft flange |
| 5 Inner tapered roller bearing | 16 Outer tapered roller bearing |
| 6 Radial sealing ring | 17 Dust cap |
| 7 Seal running ring | 18 Radial sealing ring |
| 8 Slot nut | 19 Brake carrier |
| 9 Spacer sleeve | |
| 10 Brake cable control | |

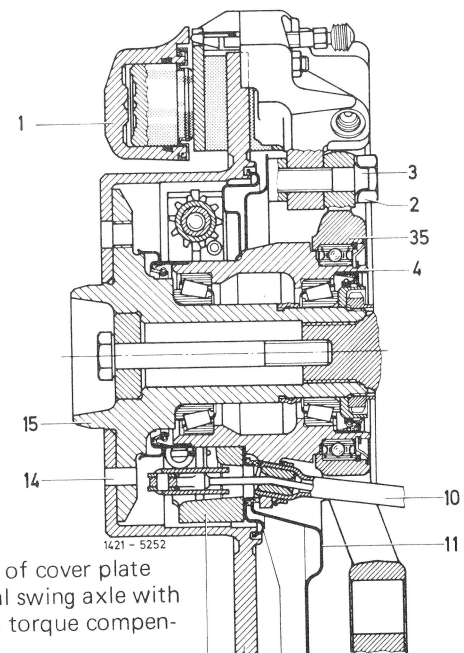

Fig. 9

Layout of cover plate diagonal swing axle with starting torque compensation

- | | |
|------------------------|---------------------------|
| 1 Caliper | 15 Rear axle shaft flange |
| 2 Hex. screw | 19 Brake carrier |
| 3 Lock plate | 35 Caliper brakcet |
| 4 Wheel carrier | |
| 10 Brake cable control | |
| 11 Cover plate | |
| 12 Brake disc | |
| 13 Supporting web | |
| 14 Set pin | |